

SYSTEM DELETE

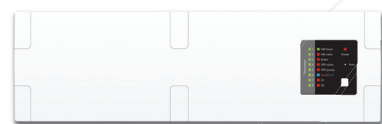

SYSTEM DELETE

iT600 System



SALUS Wiring Centre KL10RF



RX10RF



CO10RF



VS10/20RF Thermostat



TRV10RF



If at any time you need to delete ALL installed iT600 devices from your Zigbee network follow the steps below. As this procedure can have a serious affect on your heating / cooling system. It should only be carried out by your installer.



 Press for 15 seconds to activate identify mode.

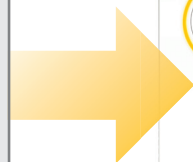

The button colour will change to AMBER to indicate system delete. At this point, the procedure cannot be cancelled.



After all devices have been deleted from the Zigbee network, they will need to be re-installed. Please refer to all relevant instruction manuals.

WARRANTY

SALUS Controls warrants that this product will be free from any defect in materials or workmanship, and shall perform in accordance with its specification, for a period of five years from the date of installation. SALUS Controls sole liability for breach of this warranty will be (at its option) to repair or replace the defective product.

Customer Name:

Customer Address:

..... Post Code:

Tel No: Email:

Engineers Company:

Tel No: Email:

Installation Date:

Engineers Name:

Engineers Signature:

TECHNICAL DETAIL

Model	CO10RF
Type	Zigbee Coordinator
Function	Zigbee network coordinator for iT600 system
Control	Open - Close the Zigbee network
Indication	Tri Colour LED - RED - GREEN - AMBER
User Interface	Single push button
Operating Temperature	0 to 50 °C
Storage Temperature	-20°C to 60°C
Frequency	2.4 GHz
Power Source	230V 50Hz via mains adaptor (supplied)
Approval	CE

SALUS
CONTROLS
Zigbee Coordinator
Models: CO10RF



INSTALLER / USER MANUAL

SALUS Controls plc

SALUS House
Dodworth Business Park South,
Whinby Road,
Dodworth, Barnsley S75 3SP, UK.

SALES: T: +44 (0) 1226 323961
E: sales@salus-tech.com

TECHNICAL: T: +44 (0) 1226 323961
E: tech@salus-tech.com

www.salus-controls.com



SALUS Controls is a member of the Computime Group

Maintaining a policy of continuous product development SALUS Controls plc reserve the right to change specification, design and materials of products listed in this brochure without prior notice.

For PDF Installation guide please go to
www.salus-controls.com

00086/2 Issue Date: June 2014

Box Contents



1 x Installer / User manual



1 x CO10RF

1 x USB Adapter
1 x UK Plug + EU Plug AdapterFor PDF Installation guide please go to
www.salus-controls.com
Product Compliance

- Electro-Magnetic Compatibility directive 2004 / 108 / EC
- Low voltage Directive 2006/95/EC

Warning

These instructions are applicable to the SALUS model stated on this instruction guide.

This product must be fitted by a competent person, and installation must comply with the guidance, standards and regulations applicable to the city, country or state where the product is installed. Failure to comply with the requirements of the relevant guidance, standards and regulations could lead to injury, death or prosecution.

Warning

Always isolate the AC Mains supply before installing or working on any components that require 230 VAC 50Hz supply.

We hope you enjoy this product...

SYSTEM OVERVIEW

INTRODUCTION

Thank for purchasing the SALUS CO10RF Zigbee coordinator. The Zigbee coordinator controls the Zigbee communication of your i6000 system.

Please refer to individual device manuals for more information.

The Zigbee coordinator must be used with the i6000 RF range of products below:

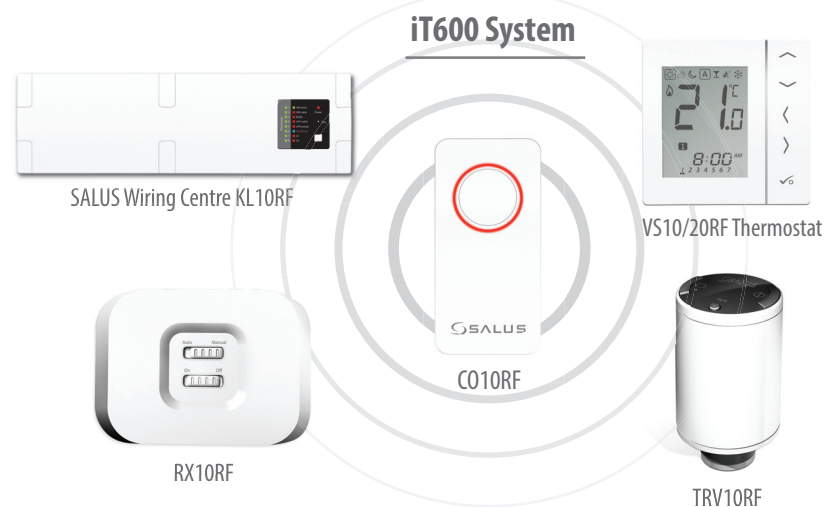

INSTALLATION

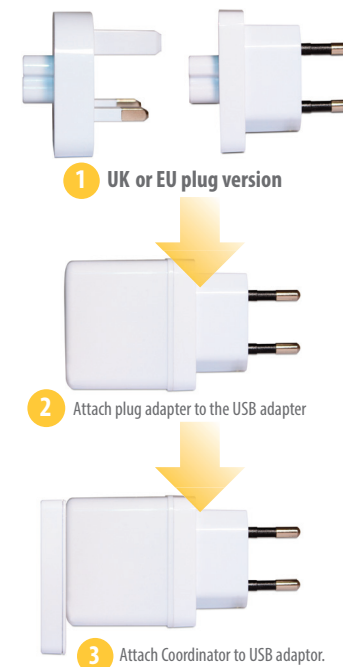

INSTALLATION



4 Insert the adaptor into 230V mains outlet.



5 Switch the 230V mains outlet on and ensure the button is illuminated (red) as shown above.

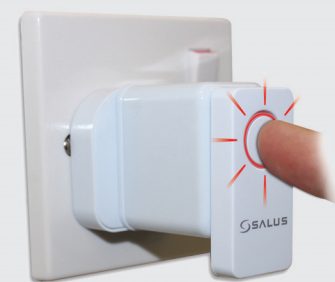

6 To commence system installation press and hold the button until for 5 seconds or the button starts flashing red. This means the Zigbee network is ready to accept i6000 devices.



8 When everything is paired press and hold button for 5 seconds or flashing stops.

Maintenance

If replacing or adding i6000 devices please ensure you follow steps 6 to 8.

CHECKING SYSTEM CONFIGURATION

To check that the complete system is communicating and has been configured correctly, you can use identify mode.

Using identify from the coordinator will show all products that are connected to your system.

